

RLK16-1200B8-A

12MP 16-Channel PoE Security System with Smart Detection & 24/7 recording.

- 12MP Ultra HD
- Person/Vehicle Detection
- 4TB HDD 16-Channel NVR

Specifications

Hardware	
Hardware	V2
Video/Audio Input	
IP Video Input	PoE IP camera x 16
Audio Input	Cameras with built-in mic
Video/Audio Output	
Video Output	VGA, HDMI
Display Resolution	• HDMI: 3840*2160, 1920*1080, 1280*1024, 1280*720, 1024*768 • VGA: 1920*1080, 1280*1024, 1280*720, 1024*768
Audio Output	1-channel, RCA
Decoding	
Live View/Playback Resolution	7680×2160, 4608×1728, 4512×2512, 4096×3072, 3840×2160, 2560×2560, 2560×1920, 2560×1440, 2048×1536, 2304×1296, 1080p, 720p
Video Format	H.265, H.264
Synchronous Playback	Up to 4 channels

HDD	
SATA	2 x SATA interface (1 x 4TB HDD included)
Capacity	Up to 12TB (max. 6TB capacity for each HDD)
External HDD	No
External Interface	
USB Interface	x USB 2.0
Network Interface	<ul style="list-style-type: none"> · 1, RJ-45 10/100/1000 Mbps self-adaptive Ethernet interface for LAN/WAN · 16, RJ-45 10/100 Mbps self-adaptive PoE Ethernet interface for IP camera
PoE	
Max. Power Per Port	25W
Supported Standard	IEEE 802.3 af/at
Network	
Network Protocol	HTTP, TCP/IP, UDP, DHCP, P2P, UPNP, RTSP, SMTP, SSL/TLS, DNS, DDNS, NTP, FTP
Browser Supported	Firefox, Chrome, Edge, Safari
OS Supported	PC: Windows, Mac OS; Smartphone: iOS, Android
Max. User Access	20 users (1 admin account & 19 user accounts); up to 12 simultaneous video streams (10 substreams & 2 mainstreams)
General	
Power Supply	DC 48V~54V
Power Consumption	<10W (without HDD & PoE)
Working Environment	Temperature: -10°C~+45°C (14°F~113°F); humidity: 10%~90%
Dimensions	330 x 45 x 285mm
Weight	2.4kg

Warranty

Limited Warranty

2-year limited warranty. For support, visit <https://support.reolink.com/hc/en-us/>.

Gallery & Specs



1. Mount
2. Speaker
3. Metal Aluminum Case
4. Spotlight
5. IR LEDs
6. High Definition Lens
7. Daylight Sensor
8. Built-In Mic

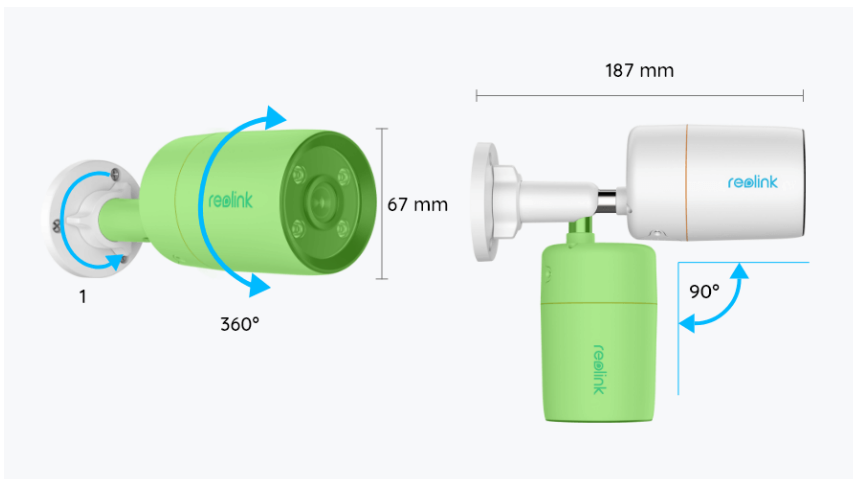

1. Unscrew it (counterclockwise) to loosen the bracket and adjust the camera in any direction.
2. After adjustment, twist it back to fix the camera.

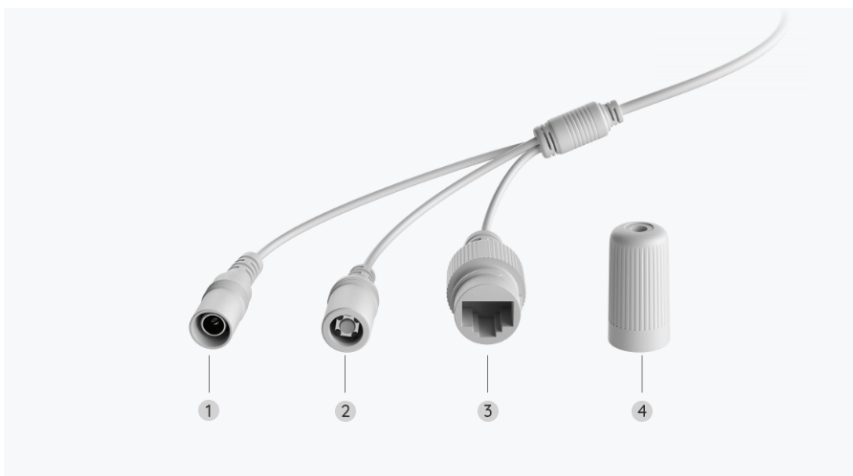

1. Power
2. Reset Button
3. Network
4. Waterproof Lid



1. USB Port
2. Power LED/HDD LED
3. Control Panel

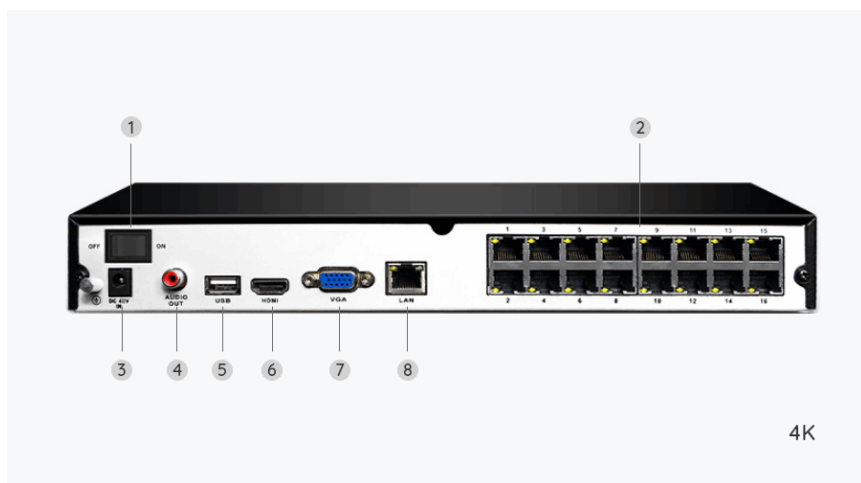

1. On/Off Switch
2. RJ45
3. Power Input
4. Audio Out
5. USB Port
6. HDMI Port
7. VGA Port
8. Network