

RLC-842A

8MP Ultra HD Smart PoE Camera with Person/Vehicle Detection and 5X Optical Zoom.

- Person/Vehicle Detection
- 4K 8MP Ultra HD
- 5X Optical Zoom

Specifications

Video & Audio	
Image Sensor	1/2.8" CMOS sensor
Video Resolution	Default: 3840 x 2160 (8.0 Megapixels) at 25 fps
Lens	f=2.7-13.5mm; F=1.6-3.3
Optical Zoom	5X
Video Compression	H.265
Field of View	• Horizontal: 105°-31° • Vertical: 55°-17°
Day & Night	Auto-switching
Night Vision	30 Meters (100 ft) (LED: 24pcs/14mil/850nm)
Audio	Audio recording
Power	
PoE	IEEE 802.3af, 48V Active
DC Power	DC 12.0V 1A, <12W
Interface	

Power	DC power port
System	Reset button
Ethernet	One 10M/100Mbps RJ45
Storage	MicroSD card slot (max. 256GB)
Audio	Built-in microphone
Software Features	
Frame Rate	· Mainstream: 2fps - 25fps (default: 25fps) · Substream: 4fps - 15fps (default: 10fps)
Code Rate	· Mainstream: 4096Kbps - 8192Kbps (default: 6144Kbps) · Substream: 64Kbps - 512Kbps (default: 256Kbps)
Browser Supported	Edge, Chrome, Firefox, Safari
OS Supported	PC: Windows, Mac OS; Smartphone: iOS, Android
Smart Alarm	Motion detection; person detection; vehicle detection; pet detection
Record Mode	Motion-triggered recording (default); scheduled recording; 24/7 recording
Protocols & Standards	HTTPS, SSL, TCP/IP, UDP, HTTP, IPv4, UPnP, RTSP, RTMP, SMTP, NTP, DHCP, DNS, DDNS, FTP, P2P
Maximal User Access	20 users (1 admin account & 19 user accounts); Support up to 12 simultaneous video streams (10 substreams & 2 mainstreams)
Smart Home	Google Assistant
Working Environment	
Temperature	Operating temperature: -10°C~+55°C (14°F~131°F)
Humidity	Operating humidity: 10% ~ 90%
Waterproof	IP66
Vandal-proof	IK10
Size & Weight	

Dimensions	Φ133*100.25mm
Weight	686g
Warranty	
Limited Warranty	2-year limited warranty. For support, visit https://support.reolink.com/hc/en-us/

Gallery & Specs



1. Metal Aluminum Case
2. IR LEDs
3. High Definition Lens
4. Daylight Sensor

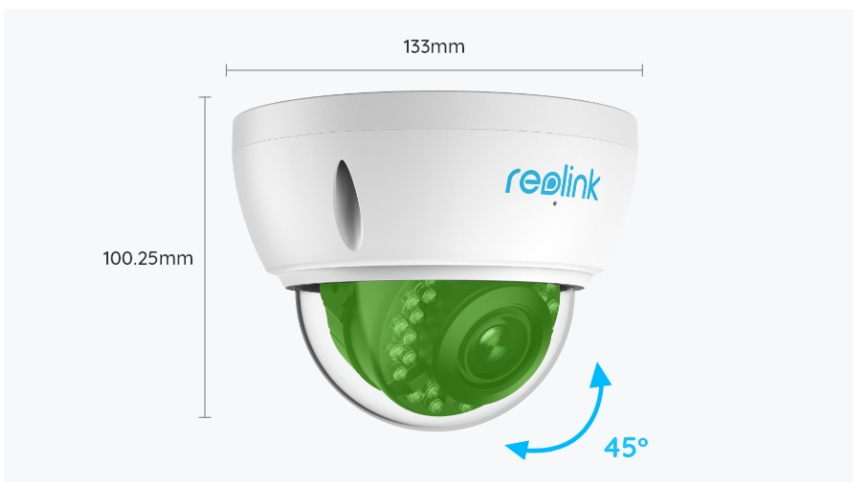

You can manually rotate it to get the best monitoring angle.

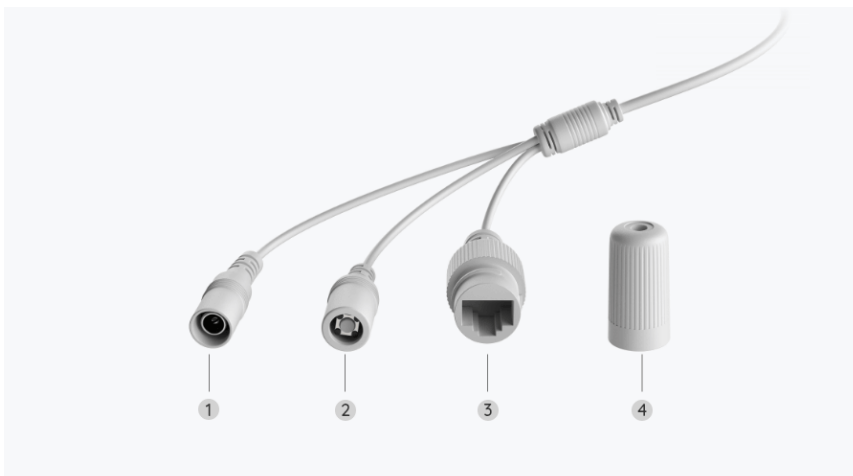

1. Power
2. Reset Button
3. Network
4. Waterproof Lid

