

RLC-510WA

Smart 5MP WiFi Security Camera with Person/Vehicle Detection & Audio Recording.

- Person/Vehicle Detection
- 5MP/4MP Super HD
- 2.4/5 GHz WiFi

Specifications

Video & Audio	
Image Sensor	1/2.7" CMOS Sensor
Video Resolution	Default: 2560 x 1920 (5.0 megapixels) at 20 frames/sec
Lens	f=4.0mm fixed, F=2.0, with IR cut
Video Compression	H.264
Field of View	• Horizontal: 80° • Vertical: 42°
Day & Night	IR-cut filter with auto-switching
Night Vision	30 meters (100ft) (LED: 18pcs/14mil/850nm)
Audio	Audio recording
Power	
DC Power	DC 12.0V 1A, <12W
Interface	
Power	DC power port
System	Reset button
Ethernet	One 10M/100Mbps RJ45

Storage	microSD card slot (Max. 256GB)
Audio	Built-in microphone
Software Features	
Frame Rate	• Mainstream: 2fps - 30fps (default: 20fps) • Substream: 4fps - 15fps (default: 10fps)
Code Rate	• Mainstream: 1024Kbps - 8192Kbps (default: 4096Kbps) • Substream: 64Kbps - 512Kbps (default: 256Kbps)
Browsers Supported	Edge, Chrome, Firefox, Safari
OS Supported	PC: Windows, Mac OS; Smartphone: iOS, Android
Smart Alarm	Motion detection/human detection/vehicle detection
Recording Mode	Motion recording; scheduled recording; 24/7 recording
Protocols & Standards	HTTPS, SSL, TCP/IP, UDP, HTTP, IPv4, UPnP, RTSP, RTMP, SMTP, NTP, DHCP, DNS, DDNS, FTP, P2P
Maximal User Access	20 users (1 admin account & 19 user accounts); Supports up to 12 simultaneous video streams (10 substreams & 2 mainstreams)
Work with	Google Assistant
Wireless	
Wireless Standard	IEEE 802.11a/b/g/n
Operating Frequency	2.4GHz/5GHz
Wireless Security	WPA-PSK/WPA2-PSK
Working Environment	
Operating Temperature	-10°C~+55°C (14°F~131°F)
Operating Humidity	10% ~ 90%
Waterproof	IP67
Size & Weight	

Dimension	Φ67 x 186mm
Weight	415g
Warranty	
Limited Warranty	2-year limited warranty. For support, visit https://support.reolink.com/hc/en-us/ .

Gallery & Specs



1. Antenna
2. Mount
3. Metal Aluminum Case
4. 18 IR LEDs
5. High Definition Lens (f=4.0mm)
6. Daylight Sensor

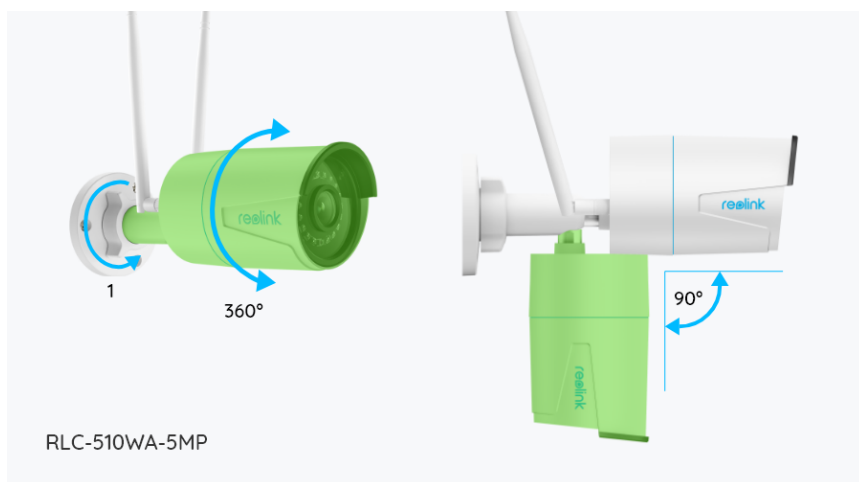

1. Unscrew it (counterclockwise) to loosen the bracket and adjust the camera in any direction.
2. After adjustment, twist it back to fix the camera.

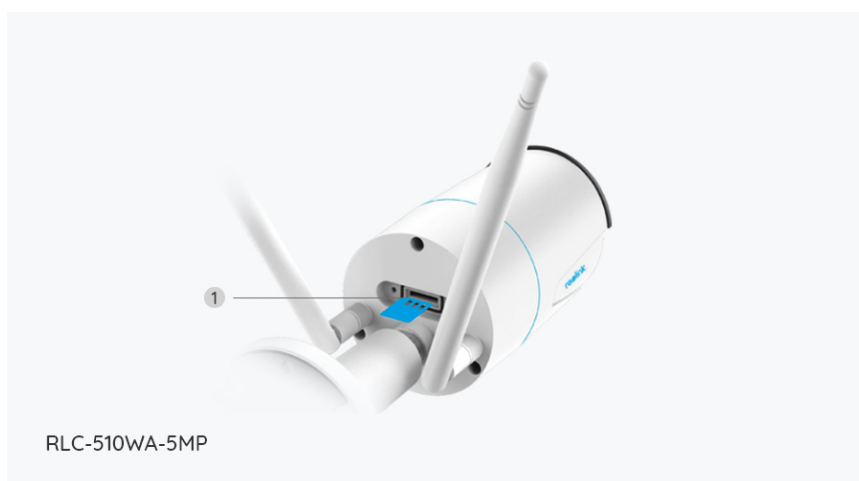

1. Micro SD Card Slot



1. Power
2. Reset Button
3. Network
4. Waterproof Lid



1. Antenna
2. Mount
3. Metal Aluminum Case
4. 18 IR LEDs
5. High Definition Lens (f=4.0mm)
6. Daylight Sensor

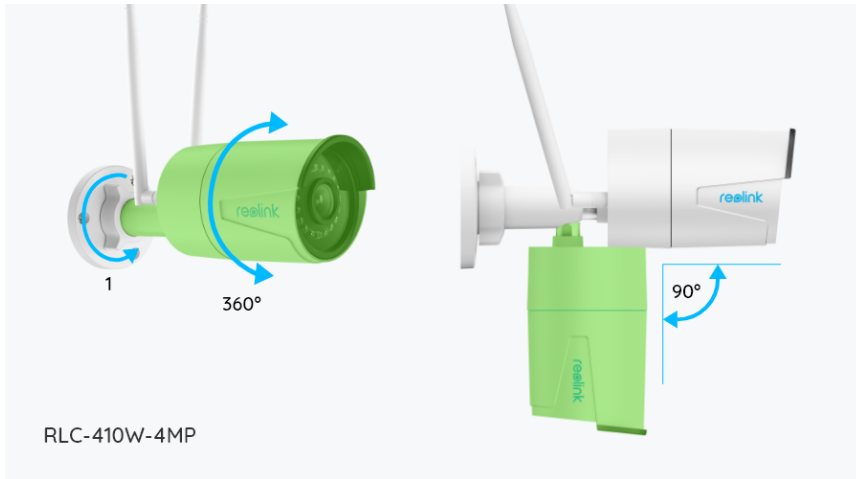

1. Unscrew it (counterclockwise) to loosen the bracket and adjust the camera in any direction.
2. After adjustment, twist it back to fix the camera.



1. Micro SD Card Slot



1. Power
2. Reset Button
3. Network
4. Waterproof Lid

www.reolink.com