

PYRAMID™

PL100

Electronic Digital Door Lock
(Indoor Use Only)

Installation Guide



Don't Forget:

Register your product online:
pyramidthimesystems.com/productregistration

Copyright Information

© 2024 Pyramid, LLC. All rights reserved.

Reproduction, adaptation or translation without prior written permission is prohibited, except as allowed under the copyright laws.

The information contained herein is subject to change without notice. The only warranties for Pyramid are set forth in the express warranty statements accompanying such products. Nothing herein should be construed as constituting an additional warranty. Pyramid shall not be liable for technical or editorial errors or omissions contained herein.

TABLE OF CONTENTS

PRODUCT OVERVIEW 2

FEATURES 2

CONTENTS 3

PRE-INSTALLATION 4

LEVER DIRECTION 4

LEVER ADJUSTMENT FRONT PANEL 5

LEVER ADJUSTMENT BACK PANEL 6

TEMPLATE SETUP 7

LATCH INSTALLATION 7

FRONT PANEL INSTALLATION 7

BATTERY CHASSIS INSTALLATION. 8

BACK PANEL INSTALLATION 8

INSTALLATION TEST 8

STRIKE PLATE INSTALLATION 8

WARRANTY 9

ELECTRONIC DIGITAL DOOR LOCK INSTALLATION

Model PL100

PRODUCT OVERVIEW

Thank you for choosing a **PL100 Electronic Digital Door Lock!**

The PL100 is a wireless electronic digital door lock that features digital code access, proximity card /fob access, and a manual key! Easy to install and instant security to any room with up to 200 users (Codes or/and proximity cars/fobs).

Please read through this User Guide for easy installation and simple set-up.

PL100: FEATURES

User Capacity	Total 200 (code, proximity card/fob)
Material	Zinc Alloy
Weight	5.1lbs
Power	4 AA Batteries (Not Included).
Reset Options	Full Master Reset (erases to factory/default setup)
User Management	Erase individual user access or all users
Code Access	Create 4 - 8 digit access codes
Fob/Card Access	Pyramid Proximity Card (see available part #)
Emergency Access	2 Keys supplied for key entry
Door Open Direction	Universal mount on right or left side
Keypad	Standard 12-key keypad with illumination
Battery Life	1 year battery life with low voltage indicator
Tamper-Proof	After 4 faulty attempts lock is disabled for 30 sec.
Warranty	1-Year manufacturer's limited warranty

ELECTRONIC DIGITAL DOOR LOCK INSTALLATION

Model PL100

CONTENTS

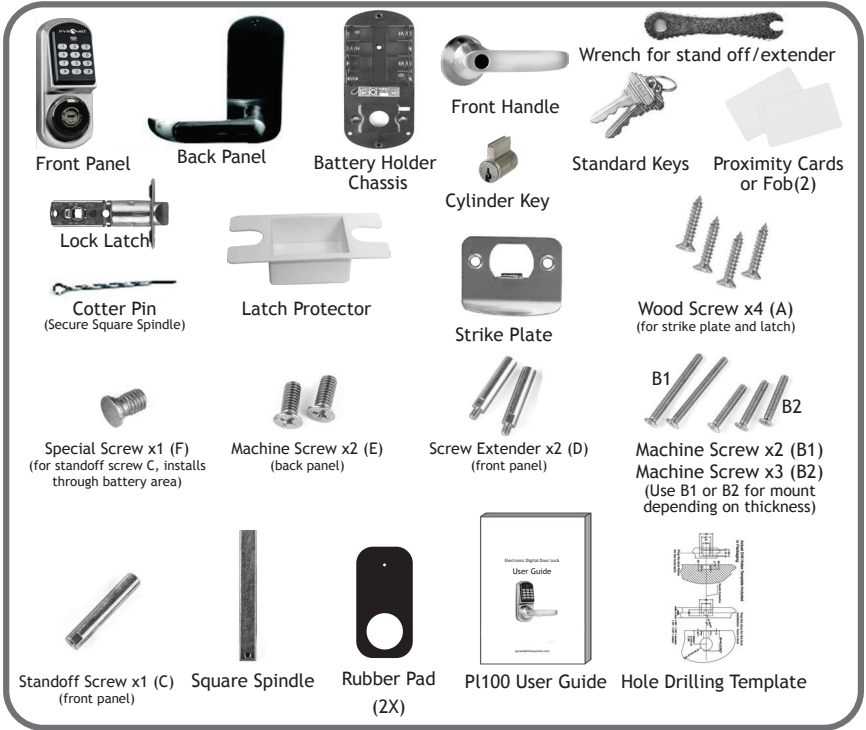

WHAT YOU WILL NEED

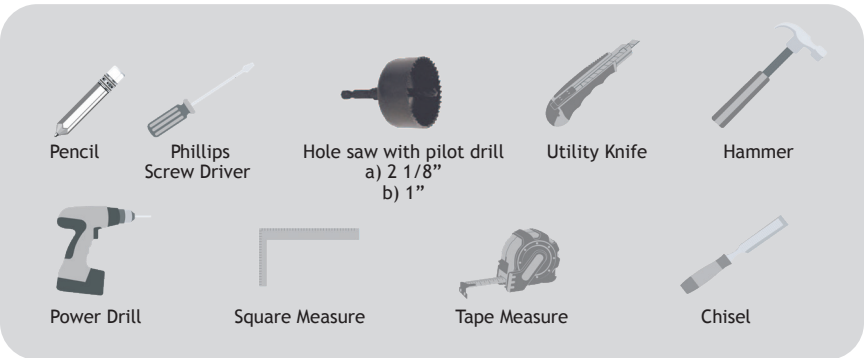

ELECTRONIC DIGITAL DOOR LOCK INSTALLATION

Model PL100

Pre-Installation Steps

- ① Measure Door Thickness
- ② Standard Door Thickness is 35-45mm (1 3/8" to 1 3/4")
If the Door is More Than 45mm and up to 110mm (1 3/4"-4 3/8")
You'll Need To Use Custom Accessories Included. See #5 on the Front Panel Installation steps sheet page 7.

Lever Direction

- ③ Confirm direction of the door lock will be mounted on to adjust proper direction of lock handle lever.

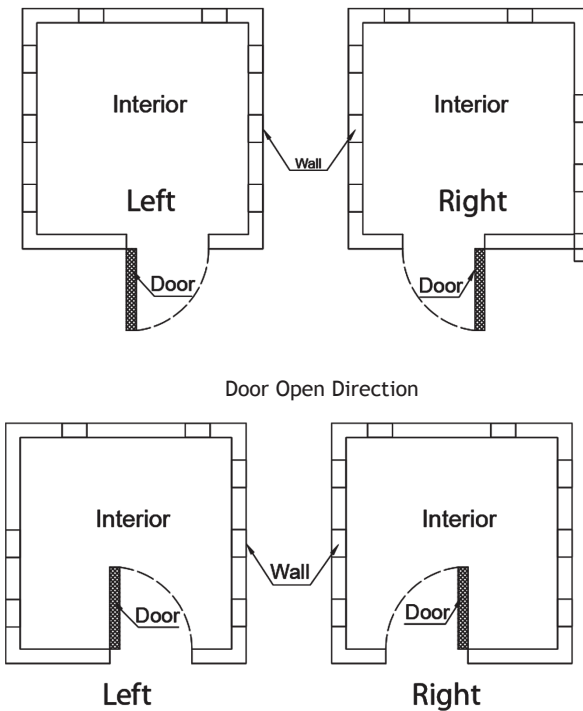

ELECTRONIC DIGITAL DOOR LOCK INSTALLATION

Model PL100

Lever Adjustment Front Panel

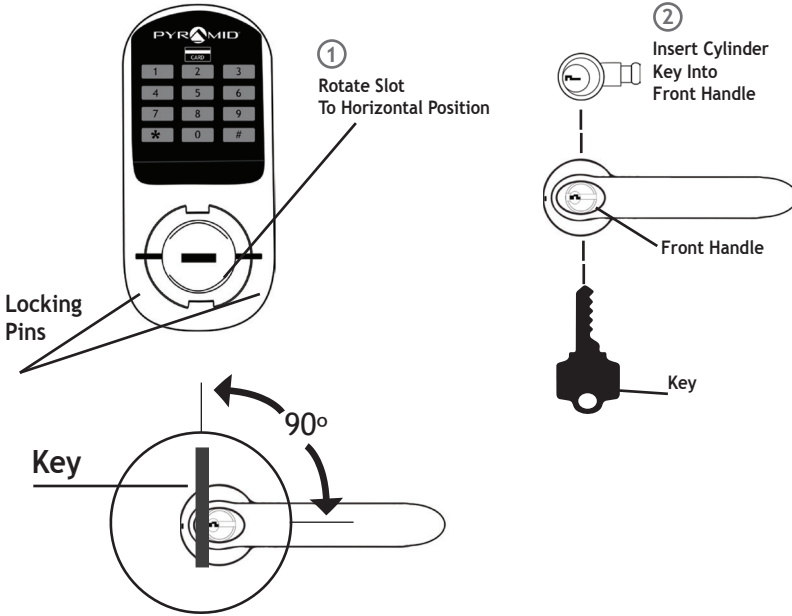

- ③ Insert and turn key 90° in the front handle
- ④ Insert the “pilot” of cylinder key into “slot” (horizontal position).
- ⑤ Next, push “in” the locking pins” and slide the front handle until locking pins get in the handle.
- ⑥ Turn back and remove the key.

The front handle can be mounted on the front panel for Right or Left door

Front Handle Removal

- ① Insert and turn key 90° in the front handle
- ② Push in locking pins and pull the handle out

Lever Adjustment Back Panel

- ① Loosen the screw
- ② Slowly rotate the handle to the other side
- ③ If handle jams, loosen screw a bit more
- ④ Adjust the handle direction as desired
- ⑤ Re-tighten Screw

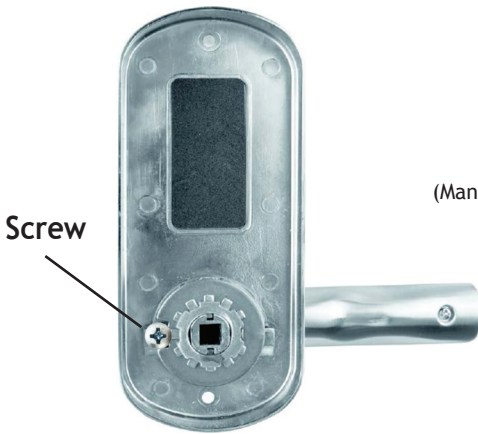

Back Panel

(Manufactured set “right” door open directions)

Watch video at:
pyramidthimesystems.com/tutorials

ELECTRONIC DIGITAL DOOR LOCK INSTALLATION

Model PL100

Template Set-up

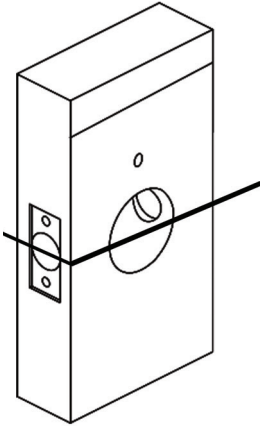

- 1 Measure 1 meter (39.37") from ground and draw a horizontal line on all three sides of door
- 2 Align *door template with horizontal line centered in handle centerline and mark drill holes.
- 3 Drill all holes marked using door template.

Door template included in packaging

Latch Install

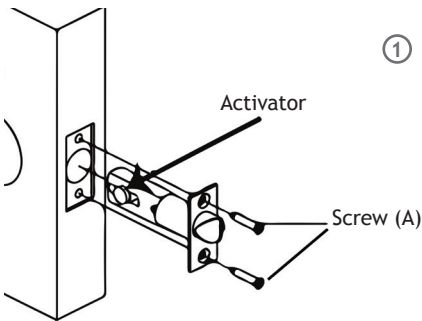

- 1 Align latch, adjust activator to center of hole (2 3/8" or 2 3/4") and secure by using two (A) screws.

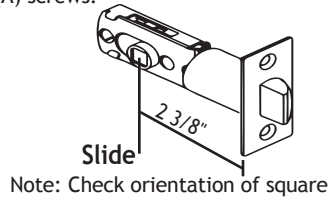

Front Panel Install

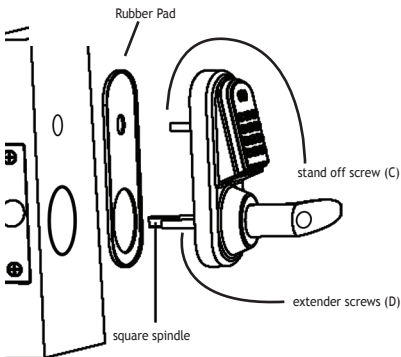

- 1 Insert square spindle (side with hole to front panel), secure by cotter pin and bend pin leads.
- 2 Install screw extenders (D) on front panel and tighten
- 3 Place rubber pad between front panel/door.
- 4 Square spindle goes into square hole latch activator and main wire goes through the main hole.

Custom Door widths 1 3/4" to 4 3/8"

- 5 Install the stand off (C) using special screw (F) and insert into front panel and tighten with wrench.

ELECTRONIC DIGITAL DOOR LOCK INSTALLATION

Model PL100

Battery Holder Chassis Install

- 1 Place rubber pad between chassis/door and pull wire through wire hole in chassis.
- 2 Attach battery holder chassis with screws B1 or B2 (depends on door width)
- 3 Connect wire harness to battery connector

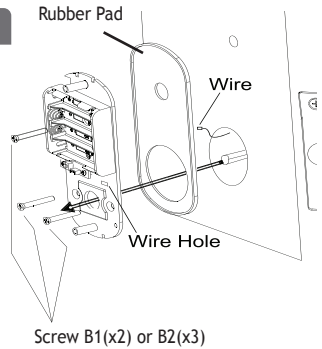

Back Panel & Battery Install

- 1 Install 4 AA alkaline batteries (Not included).
- 2 Install back panel with 2 screws (E)

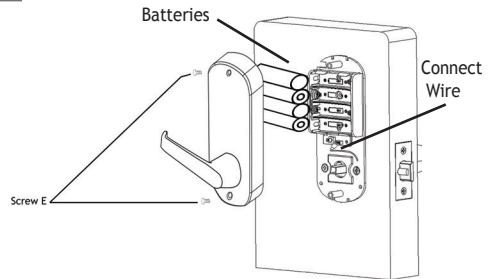
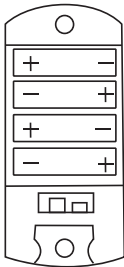

Installation Test

- 1 Check the flexibility of inside/outside door handles.
- 2 Test standard keys

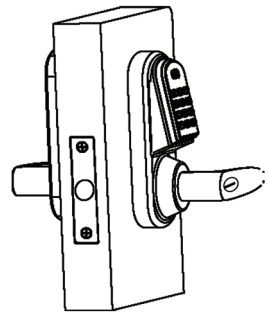

Strike Install

- 1 Install latch protector and strike plate with 2 screws (A)

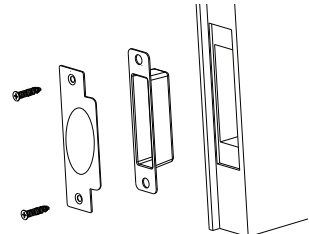

ELECTRONIC DIGITAL DOOR LOCK INSTALLATION

Model PL100

LIMITED HARDWARE WARRANTY

- Pyramid Time Systems warrants its equipment to original user against defective material or workmanship for a period of 1-year from date of purchase. Proof of purchase and purchase date are required for warranty service on this product.
- Pyramid Time Systems responsibility under this warranty is limited to replacement of defective part(s). Replacement is the sole discretion of Pyramid Time Systems.
- For Return Shipments to Pyramid Time Systems, product must be shipped in its original carton or equivalent. The return freight method and cost for warranted product is the sole responsibility of the customer. Pyramid Time Systems will not assume any responsibility for loss or damage incurred in shipping.
- Pyramid Time Systems reserves the right to determine whether parts failed because of defective material, workmanship or other causes.
- Failure caused by accident, alteration, misuse or improper packaging of returned unit is not covered by this warranty.
- Any repair done by the customer without the consent from Pyramid Time Systems will automatically void the warranty.
- Users in countries other than Canada and USA should contact the Dealer from whom the unit was purchased.
- The rights under this warranty are limited to the original user and may not be transferred to subsequent users.

MONEY BACK GUARANTEE

Pyramid Time Systems offers a 30-day money back guarantee. If an RMA is issued for an unwanted product before 30 days, Pyramid Time Systems will refund the entire purchase price less shipping if purchased from Pyramid Time Systems. Pyramid Time Systems will assess a 15% restocking fee on any returns received between 31 and 60 days from the date of purchase. No returns will be accepted after 60 days. Pyramid Time Systems will not issue a call tag for pickup of products. Customers are responsible for shipping the product back including the cost of shipping. Pyramid Time Systems will assume the cost of ground shipping for the replacement product to the customer. Pyramid Time Systems will also assess a 15% fee if any item(s) are missing in an open box return. Shipping back to Pyramid Time Systems from a Pyramid Time Systems Partner is the responsibility of the Pyramid Time Systems Partner. No call tags will be issued. Items returned to Pyramid Time Systems without an RMA will not be credited.