

IP Camera

KNC-HMS6330-iB

- 1/2.8" 2.13MP Sony STARVIS CMOS
- 1080p(1920x1080)@30(25)fps
- H.264 Main/Baseline Profiles
- Fixed lens 3.6mm or Pinhole lens 4.3mm
- Electronic Day&Night
- 3D DNR, DSS, BLC, WDR
- 12VDC / PoE
- 2 seconds boot-up complete

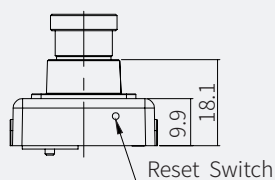
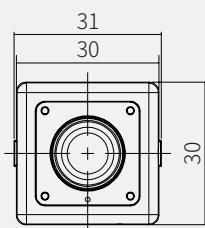

Dimensions

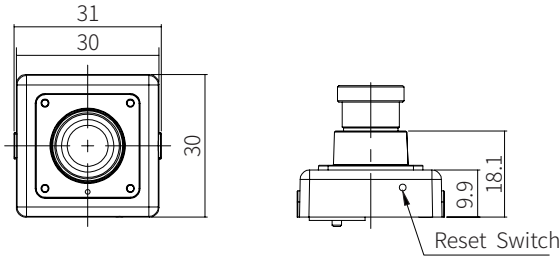

Specifications

Image Sensor	1/2.8" Progressive Scan SONY STARVIS CMOS	
Effective Pixels	1945(H) x 1097(V)	
Scanning	Progressive scan	
Min.Illumination	0.05Lux(F2.5, DSS Off) / 0.01Lux(DSS On)	
S/N ratio	≤50dB	
Video Output	Network	Network
	Analog	-
	Type	Fixed lens
Lens	Focal Length	3.6mm, F 2.0
	Angle of View	-
	2.8mm	131 (D)x113 (H)x63 (V)
Board Lens	3.6mm	112.3 (D)x93.7 (H)x49.3 (V)
	6.0mm	62.1 (D)x53.9 (H)x30.1 (V)
	8.0mm	44.8 (D)x39.3 (H)x22.4 (V)
	4.3mm	84.3 (D)x71.5 (H)x38.4 (V)
White Balance	Auto, 3000K, 5000K, 8000K	
Dynamic Range	Method	Double Shutter WDR
	Level(dB)	116dB (Estimated)
Electronic Shutter Speed	1/25(30)~1/30,000	
Auto Gain Control(AGC)	Off~69dB	
Day&Night	AUTO/COLOR/B&W (Electronic D&N)	
Digital Slow Shutter(DSS)	OFF~ x32	
Noise Reduction	2D, 3D DNR	
Motion Detection	60x34 Motion Block, upto 4 Zones	
Privacy Masking Zone	16 Zones	
	Alarm In/Out	-
Alarm	Alarm Triggers	Motion
	Alarm Events	Network

Ethernet	10/100 Base-T Ethernet	
Video Compression Format	H.264 Baseline, Main Profile, MJPEG	
Video Resolution	1920x1080, 1280x720,, 800x600, 704x480, 704x400, 640x480, 640x360, 320x240	
Max. Frame Rate	First: 1080p 30(25)fps (H.264) Second : 640x360 30(25)fps (H.264) Third : 1080p 30(25)fps (MJPEG)	
Streaming Capability	Multiple Streaming(Up to 3 Profiles)	
Streaming Method	Unicast	
Bitrate Control	H.264 : CBR, VBR, CVBR	
Max.User Access	5	
IP	IPv4	
Protocol	HTTP, HTTPS, UPnP, DNS, DDNS, RTP/RTSP, TCP/IP, UDP, DHCP, RARP, NTP	
Security	-	
Web Viewer	Web browser	Internet Explorer, Edge, Safari, Firefox, Chrome
	Language	English
External Storage	-	
SW Integration API	Onvif	
Ingress Protection Grade	-	
Color/Material	Black / Zn	
Dimension(mm)	30mmX30mm	
Weight	Approx.79.6g (with PoE Cable)	
Operating Temperature	-10°C~+50°C	
Storage Temperature	-20°C~+60°C	
Supply Voltage	12VDC(±10%) , PoE(IEEE802.3af)	
Power Consumption	12VDC(Max.190mA), PoE (Max.3.0W)	