

VSE152

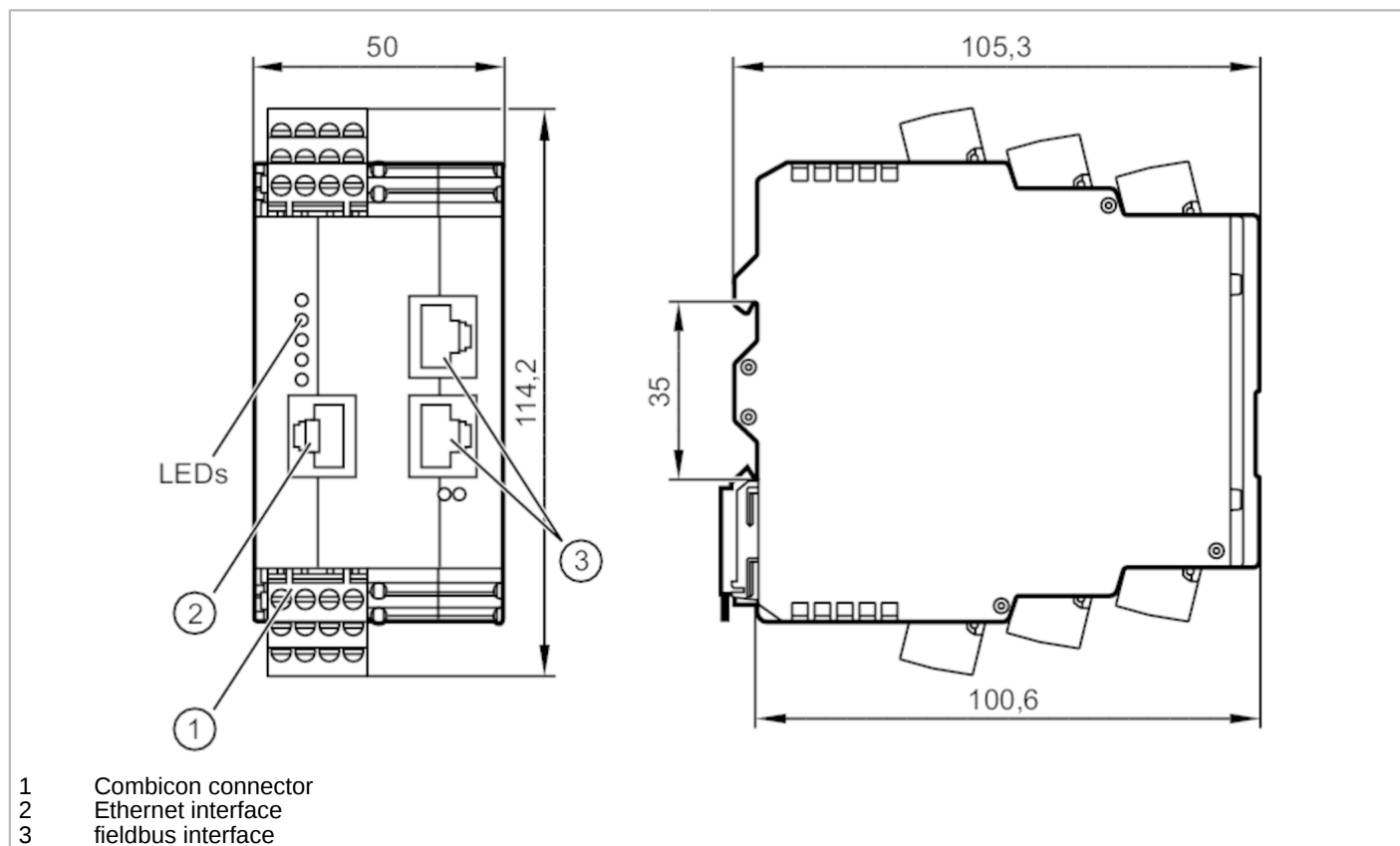

Diagnostic electronics for vibration sensors

DIAGNOSTIC ELECTRONICS



Product characteristics	
Frequency range [Hz]	0.1...12000
Communication interface	Ethernet
Application	
Design	parameter setting via PC software VES004
Application	continuous vibration monitoring
Electrical data	
Operating voltage tolerance [%]	20
Operating voltage [V]	24 DC; (when using the IEPE input: 24 V + 20%; IEPE = Integrated Electronics Piezo Electric)
Current consumption [mA]	200; ((24 V DC))
Protection class	III
Inputs / outputs	
Total number of inputs and outputs	8; (configurable)
Number of inputs and outputs	Number of analog inputs: 2; Number of dynamic inputs: 4; Number of digital outputs: 2; Number of analog outputs: 1
Inputs	
Total number of inputs	6
Number of analog inputs	2
Analog input (current) [mA]	4...20



Diagnostic electronics for vibration sensors

DIAGNOSTIC ELECTRONICS

Resolution of analog input	12
Number of dynamic inputs	4
Dynamic input - signal	0...10 mA / IEPE / 4...20 mA
Dynamic input - resolution [bit]	16
Dynamic input - frequency range [Hz]	0,1...12000
Dynamic input - sampling rate [kSamples]	100

Outputs

Total number of outputs	2
Output signal	switching signal; analog signal
Electrical design	PNP
Number of digital outputs	2; (configurable)
Output function	normally open / closed; (configurable)
Max. voltage drop switching output DC [V]	2
Permanent current rating of switching output DC [mA]	100
Number of analog outputs	1; (configurable)
Analog current output [mA]	4...20
Max. load [Ω]	500
Short-circuit protection	yes
Type of short-circuit protection	yes (non-latching)
Overload protection	yes

Measuring/setting range

Frequency range [Hz]	0.1...12000
----------------------	-------------

Interfaces

Communication interface	Ethernet
Transmission rate	10 MBaud; 100 MBaud
Protocol	EtherCAT

Operating conditions

Ambient temperature [$^{\circ}\text{C}$]	0...60
Storage temperature [$^{\circ}\text{C}$]	0...60
Protection	IP 20

Tests / approvals

EMC	EN 61000-4-2 ESD	4 kV contact discharge / 15 kV air discharge
	EN 61000-4-3	10 V/m (80...2700 MHz)
	EN 61000-4-4 Burst	4 kV capacitive coupling probe, earthed
	EN 61000-4-6	10 V 0,15...80 MHz
	EN 61000-6-4	industrial environments
MTTF [years]		91

VSE152



Diagnostic electronics for vibration sensors

DIAGNOSTIC ELECTRONICS

UL approval	Ta	0...60 °C
	Enclosure type	open Type
	voltage supply	Limited Voltage/Current
	UL approval number	L001
	File number UL	E251902

Mechanical data		
Weight	[g]	413.2
Housing		Plastic housing
Type of mounting		rail; (TH35/EN60715)
Dimensions	[mm]	114.2 x 50 x 105.3
Material		PA

Data memory		
Real-time clock		yes

Accessories		
Accessories (optional)		cross-over Ethernet patch cable for the direct connection to the PC

Remarks		
Pack quantity		1 pcs.

Electrical connection		
Combicon:		
Connection		

