

# VSE101

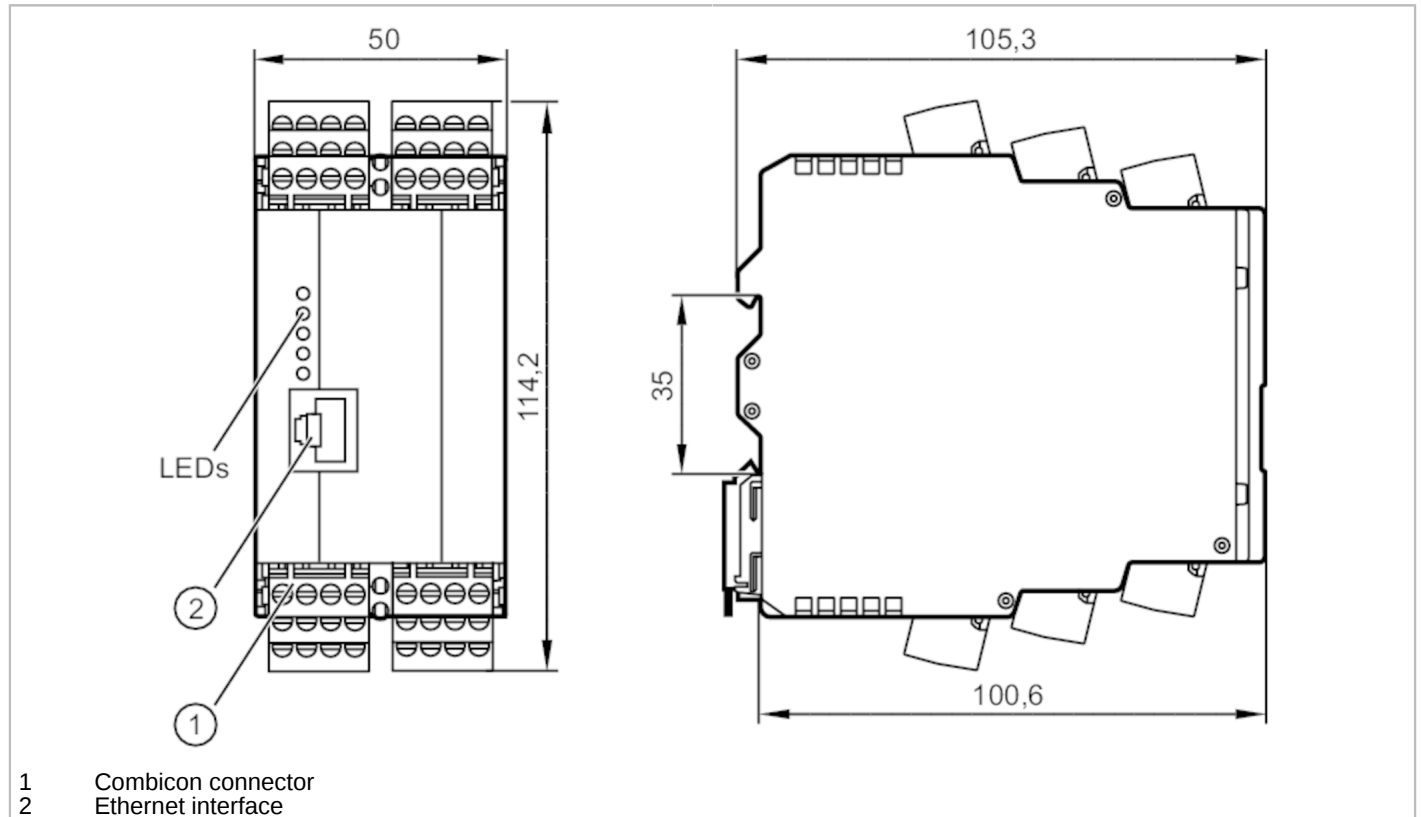

## Diagnostic electronics for vibration sensors

DIAGNOSTIC ELECTRONICS



Product characteristics	
Frequency range [Hz]	0.1...12000
Communication interface	Ethernet
Application	
Design	parameter setting via PC software VES004
Application	continuous vibration monitoring
Electrical data	
Operating voltage tolerance [%]	20
Operating voltage [V]	24 DC; (when using the IEPE input: 24 V + 20%; IEPE = Integrated Electronics Piezo Electric)
Current consumption [mA]	200; (24 V)
Protection class	III
Inputs / outputs	
Total number of inputs and outputs	16; (configurable)
Number of inputs and outputs	Number of digital inputs: 8; Number of analog inputs: 2; Number of dynamic inputs: 4; Number of digital outputs: 10; Number of analog outputs: 1
Inputs	
Total number of inputs	10
Number of digital inputs	8; (configurable)
Input circuit of digital inputs	HTL
Number of analog inputs	2



## Diagnostic electronics for vibration sensors

## DIAGNOSTIC ELECTRONICS

Analog input (current)	[mA]	4...20
Resolution of analog input		12
Number of dynamic inputs		4
Dynamic input - signal		0...10 mA / IEPE / 4...20 mA
Dynamic input - resolution	[bit]	16
Dynamic input - frequency range	[Hz]	0,1...12000
Dynamic input - sampling rate	[kSamples]	100

Outputs		
Total number of outputs		10
Output signal		switching signal; analog signal
Electrical design		PNP
Number of digital outputs		10; (configurable)
Output function		normally open / closed; (configurable)
Max. voltage drop switching output DC	[V]	2
Permanent current rating of switching output DC	[mA]	100
Number of analog outputs		1; (configurable)
Analog current output	[mA]	0...22; (0...10 V)
Max. load	[Ω]	500
Short-circuit protection		yes
Type of short-circuit protection		yes (non-latching)
Overload protection		yes

Measuring/setting range		
Frequency range	[Hz]	0.1...12000

Interfaces		
Communication interface		Ethernet
Protocol		TCP/IP

Operating conditions		
Ambient temperature	[°C]	0...70
Storage temperature	[°C]	0...70
Protection		IP 20

Tests / approvals		
EMC		EN IEC 61000-6-2
		EN IEC 61000-6-4
MTTF	[years]	89
UL approval	Ta	70 °C
	Enclosure type	Type 1
	voltage supply	Limited Voltage/Current
	File number UL	E251902

Mechanical data		
Weight	[g]	442.6

# VSE101



## Diagnostic electronics for vibration sensors

DIAGNOSTIC ELECTRONICS

Housing	Plastic housing
Type of mounting	rail; (TH35/EN60715)
Dimensions [mm]	114 x 50 x 105
Material	PA
<b>Data memory</b>	
History memory	yes
Data memory buffered	yes
Data memory type	ring memory; FIFO
Real-time clock	yes
Memory location	internal
Memory interval	min. 1 min
Memory size	881664 data records
<b>Accessories</b>	
Accessories (optional)	cross-over Ethernet patch cable for the direct connection to the PC
<b>Remarks</b>	
Pack quantity	1 pcs.



## Diagnostic electronics for vibration sensors

DIAGNOSTIC ELECTRONICS

### Electrical connection

Combicon: ; Maximum cable length: 250 m

### Connection

