

DS2505

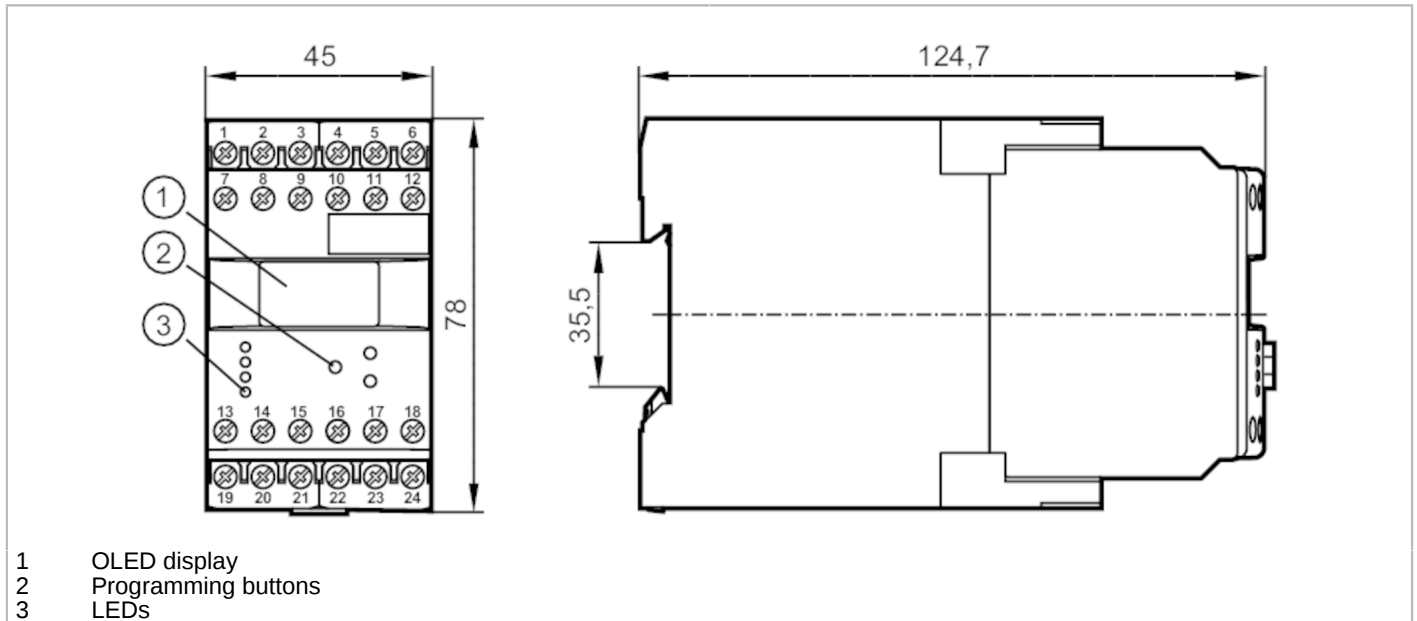

Evaluation unit for slip and synchronous monitoring

MONITOR/FS-2 /110-240VAC/DC



Product characteristics	
Dimensions	[mm] 78 x 45 x 124.7
Application	
Application	pulse evaluation system with microprocessor for slip and synchronous monitoring; evaluation of pulse differences
Electrical data	
Nominal voltage AC	[V] 110...240
Nominal voltage DC	[V] 27
Nominal voltage tolerance	[%] < 10
Nominal voltage tolerance 2	[%] 20...10
Nominal frequency AC	[Hz] 50...60
Power consumption	[W] 3
Auxiliary energy for sensors DC	[V] 19.6...27.7; (SELV, ≤ 150 mA)
Inputs / outputs	
Number of inputs and outputs	Number of relay outputs: 2
Outputs	
Number of relay outputs	2
Contact rating	6 A (250 V AC); B300, R300
Measuring/setting range	
Measuring range	[Hz] 0.1...400
Operating conditions	
Ambient temperature	[°C] -40...60
Storage temperature	[°C] -40...85
Max. relative air humidity	[%] 80; (40 °C: 50 %)
Protection	IP 50

DS2505



Evaluation unit for slip and synchronous monitoring

MONITOR/FS-2 /110-240VAC/DC

Protection rating terminals IP 20

Tests / approvals

EMC	EN 61010	2011
	EMV 89/336/EWG	
	EN 61000-6-2	2005
	EN 61000-6-4	2007

Mechanical data

Weight	[g]	377.5
Dimensions	[mm]	78 x 45 x 124.7
Material		plastics

Displays / operating elements

Display		OLED display, 128 x 64 pixels luminous
	Switching status	LED, green

Remarks

Remarks overvoltage category II; pollution degree 2

Electrical connection

dual-chamber terminals: 2 x ...2.5 mm²; AWG 14

- | | |
|----|--------------------------------|
| 1 | DC Supply voltage (L-) |
| 2 | DC Supply voltage (L+) |
| 3 | Supply transistor outputs (L+) |
| 4 | sensor signal 1 pnp |
| 5 | DC Sensor supply (L+) |
| 6 | DC Sensor supply (L-) |
| 7 | AC Supply voltage (L) |
| 8 | AC Supply voltage (N) |
| 9 | not used |
| 10 | sensor signal 1 npn |
| 11 | sensor signal 2 pnp |
| 12 | sensor signal 2 npn |
| 13 | Relay 1 common |
| 14 | Relay 1 normally open |
| 15 | Relay 1 normally closed |
| 16 | transistor output 1 pnp |
| 17 | release 1/2 pnp |
| 18 | Reset 1/2 pnp |
| 19 | Relay 2 common |
| 20 | Relay 2 normally open |
| 21 | Relay 2 normally closed |
| 22 | not used |
| 23 | not used |
| 24 | transistor output 2 pnp |