

# DS2503

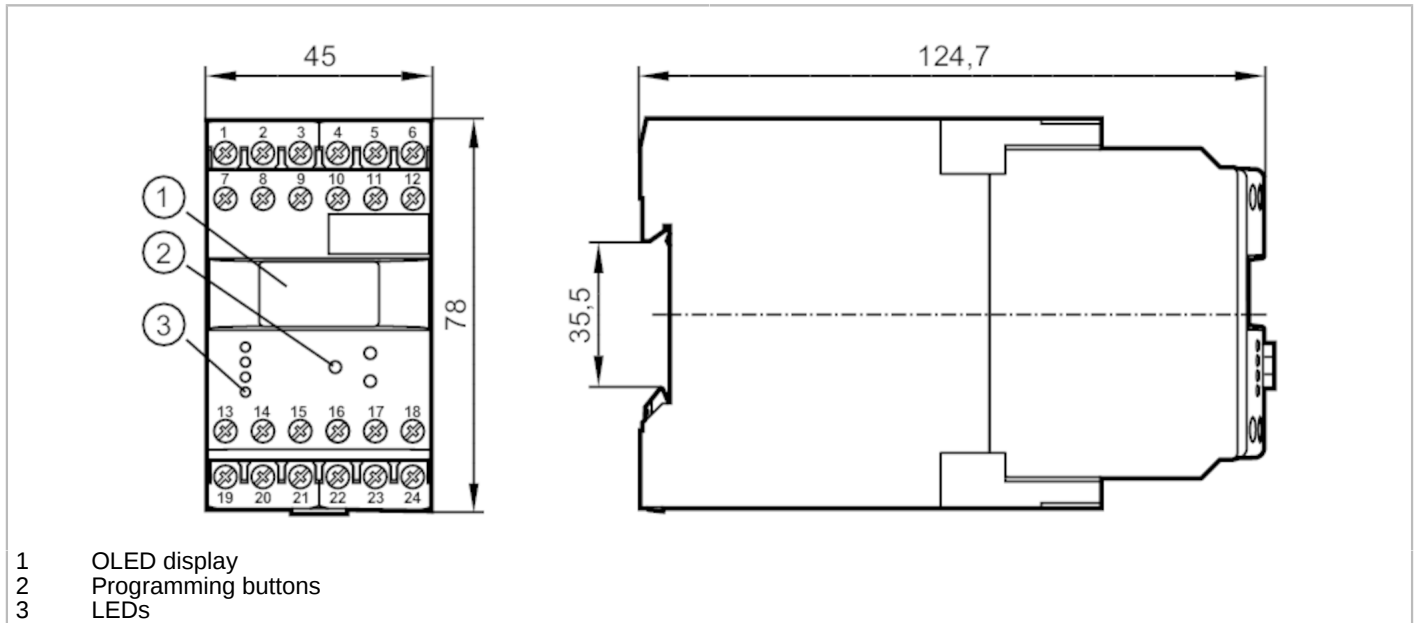

## Evaluation unit for slip and synchronous monitoring

MONITOR/FS-1 /110-240VAC/DC



- 1 OLED display
- 2 Programming buttons
- 3 LEDs



Product characteristics	
Housing	housing for DIN rail mounting
Dimensions [mm]	78 x 45 x 124.7
Application	
Application	pulse evaluation system with microprocessor for slip and synchronous monitoring as well as frequency; rotational speed and speed
Electrical data	
Nominal voltage AC [V]	110...240
Nominal voltage DC [V]	27
Nominal voltage tolerance [%]	< 10
Nominal voltage tolerance 2 [%]	20...10
Nominal frequency AC [Hz]	50...60
Power consumption [W]	3
Auxiliary energy for sensors DC [V]	19.6...27.7; (SELV, ≤ 150 mA)
Inputs / outputs	
Number of inputs and outputs	Number of relay outputs: 2
Outputs	
Number of relay outputs	2
Contact rating	6 A (250 V AC); B300, R300
Measuring/setting range	
Setting range Hz [Hz]	0.1...1000
Setting range [Imp/min]	1...60000
Operating conditions	
Ambient temperature [°C]	-40...60
Storage temperature [°C]	-40...85



## Evaluation unit for slip and synchronous monitoring

MONITOR/FS-1 /110-240VAC/DC

Max. relative air humidity [%]	80; (40 °C: 50 %)
Protection	IP 50
Protection rating terminals	IP 20

### Tests / approvals

EMC	EN 61010	2011
	EMV 89/336/EWG	
	EN 61000-6-2	2005
	EN 61000-6-4	2007

### Mechanical data

Weight [g]	382.5
Housing	housing for DIN rail mounting
Dimensions [mm]	78 x 45 x 124.7
Material	plastics

### Displays / operating elements

Display		OLED display, 128 x 64 pixels luminous
	Switching status	LED, green
	input signal	LED, green

### Remarks

Remarks	overvoltage category II; pollution degree 2
---------	---------------------------------------------

### Electrical connection

dual-chamber terminals: 2 x ...2.5 mm<sup>2</sup>; AWG 14

1	DC Supply voltage (L-)
2	DC Supply voltage (L+)
3	Supply transistor outputs (L+)
4	sensor signal 1 pnp
5	DC Sensor supply (L+)
6	DC Sensor supply (L-)
7	AC Supply voltage (L)
8	AC Supply voltage (N)
9	not used
10	sensor signal 1 npn
11	sensor signal 2 pnp
12	sensor signal 2 npn
13	Relay 1 common
14	Relay 1 normally open
15	Relay 1 normally closed
16	transistor output 1 pnp
17	Reset 1 pnp
18	Reset 2 pnp
19	Relay 2 common
20	Relay 2 normally open
21	Relay 2 normally closed
22	not used
23	not used
24	transistor output 2 pnp