

OPERATING INSTRUCTIONS

Heavy Duty Yoke Puller
MODEL 40314**HALF-ROUND YOKE(S)**

- First start by removing the large nut and washer that retains yoke to the shaft.
- Apply penetrating lubricant to splines of the shaft, wing cap bolt holes, and forcing screw of tool.
- Thread the forcing screw into the pull bar until threads begin to show through the other side.
- Hold pull bar assembly by the forcing screw and position the tool onto the yoke.

NOTE: Pull bar end reliefs should face yoke.

- Attach the adaptor cap by four bolts and then tighten down both caps.
- Hand tighten the forcing screw until the center point aligns with the shaft center.
- Using up to a 1" impact wrench, begin applying power to the forcing screw.
- Continue turning the forcing screw until yoke is completely removed.

FULL-ROUND YOKE

- Remove the large nut and washer retaining yoke to shaft.
- Apply penetrating lubricant to splines of the shaft and forcing screw of the tool.
- With the pull bar separated from the forcing screw, slide the bar through bearing cup bores until centered.
- Thread the forcing screw into pull bar until it contacts the shaft.
- Using up to a 1" impact wrench, begin applying power to the forcing screw.
- Continue turning the forcing screw until the yoke is completely removed.

Preventative Maintenance Tip:

Keep forcing screw clean and lubricated at all times with SAE 30 lube for the threads.

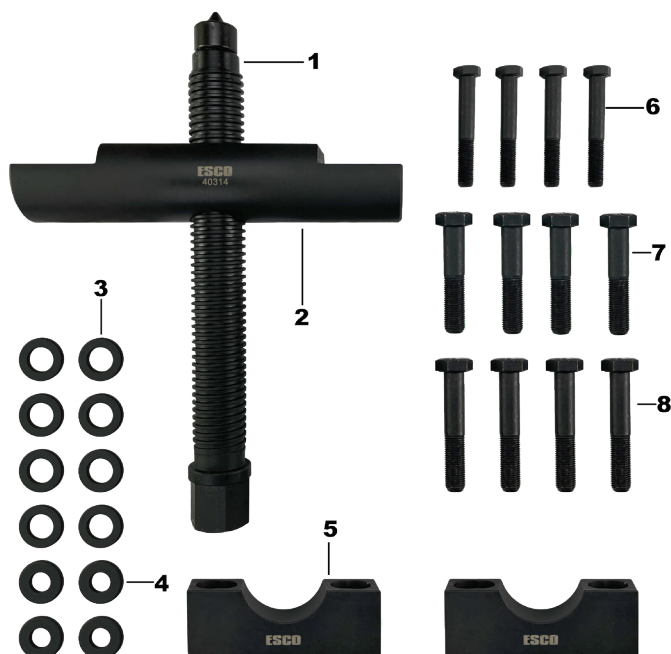
PARTS BREAKDOWN

REF NO.	PART NO.	DESCRIPTION	QTY
1	40321-1	FORCING SCREW	1
2	40321-2	PULL BAR	1
3	40321-3	WASHER(S) [FOR SCREW(S) #6]	4
4	40321-4	WASHER(S) [FOR SCREW(S) #7 & #8]	8
5	40321-5	COMBINED CAP	2
6	40321-6	3/8"-24 X 2.5"	4
7	40321-7	1/2"-20 X 2.5"	4
8	40321-8	M12-1.25 X 70MM	4