

# VersAlarm™ 4X 1-Zone Tank Alarm



Leading Edge Control Products

Rated Type 4X, Outdoor Alarm Panel, 4 x 4 Thermoplastic Enclosure

TANK ALARM (INCLUDING PUMP TERMINAL BLOCK) with CONTROL SWITCH

**TECHNICAL DATA SHEET**

## DESCRIPTION OF OPERATION



The VersAlarm™ 4X 1-Zone Tank Alarm with included auxiliary contacts is outdoor rated and powered by 120VAC or 240VAC (voltage depends on model) with conduit connections (required). The alarm includes a pump terminal block used to connect incoming pump power, pump connections, and pump switch in the same enclosure with a separate conduit entrance. When powered, the green LEDs (bottom/middle) will illuminate (solid) to indicate the alarm is powered and the included two-level press-and-hold feature can disable LEDs. Install a 9VDC lithium battery (not included) for battery backup during power outages, alarm LEDs and buzzer give two quick pulses every 10-seconds to indicate a low battery. This alarm panel can be used for a wide variety of applications, including but not limited to: septic tanks, sump pits, holding tanks, pump chambers, and water tanks.

The alarm panel is equipped with audible and visual alarm indication, activated by the normally open or normally closed float switch wired to the quick connect terminals. A variety of sensors can be used such as a float switch, pressure switch, or any "dry" type sensor that "closes" during an alarm condition (normally open or normally closed). Use the auxiliary contacts to connect to building automation systems (BAS) and phone dialers. The pump switch activates the pump to turn on and off, with the alarm enclosure used a junction box for wiring.

An alarm condition occurs when the float switch (signaling device) contact is activated, during which the red alarm LEDs will illuminate (flashing) with the left green LED illuminated (solid) for zone alarm indication, buzzer will announce with a pulse tone, and auxiliary contacts will activate. The alarm condition will stay on until the float switch is deactivated. Press and hold (1-second +) the test/silence capacitive touch button to silence the buzzer during an alarm condition, the alarm LEDs remain illuminated, flashing. The silence condition will reset when the float switch deactivates and the alarm will auto reset for the next alarm cycle. Test alarm monthly to ensure system integrity.

## STANDARD FEATURES

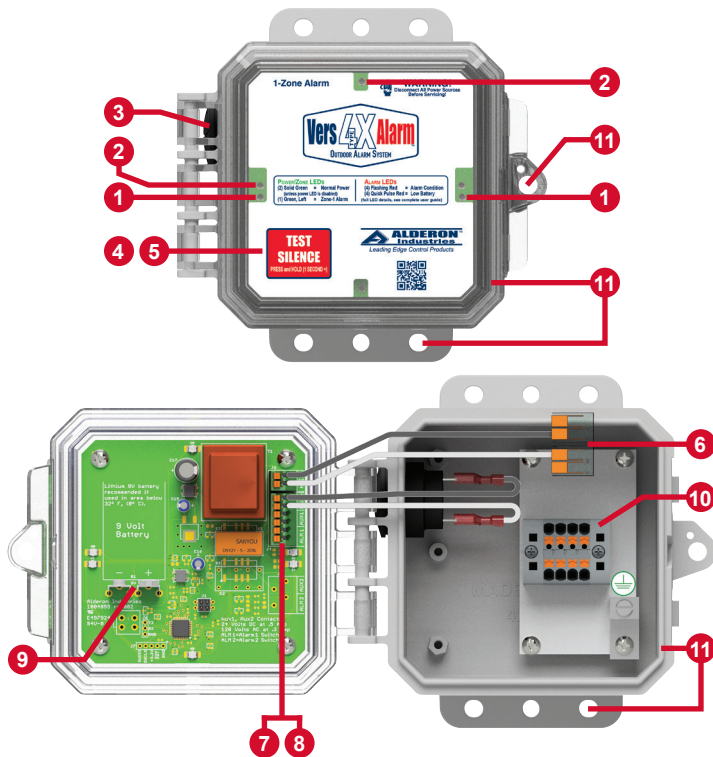

**(1) Power / Zone Indicator LEDs** - Two green LEDs (bottom/middle) illuminate (solid) to indicate the alarm is powered and the left green LED is used as a zone indicator during an alarm condition.

**(2) Alarm LEDs** - Four red LEDs illuminate (flashing) during an alarm condition (top, bottom, and top/middle) and low battery (pulse).

**(3) Alarm Buzzer** - Annunciates a pulse tone in addition to the visual indication provided by the red alarm and green zone LEDs during an alarm condition. Quick pulse tones indicate low battery.

**(4) Test/Silence Capacitive Touch Button** - Press and hold (1-second +) the button to test alarm, silence the buzzer during an alarm condition, or turn off the LEDs (green/red). Place finger in the center of the button, sensor ignores edge touches.

**(5) Power/Alarm LEDs Off** - Press and hold the test/silence button for 8-seconds to disable the green power LEDs. Press and hold for 16-seconds to disable the red low battery alarm LEDs. Repeat the process for each to turn back on.

**(6) Incoming Power Wago Connectors** - Connect incoming power to the respective Wago connectors (L1 and L2/N), the voltage and included connectors depends on model.

**(7) Auxiliary "Dry" Contacts** - Interface with an external device. The contacts (normally open) are rated 120VAC at 0.3A and 24VDC at 0.5A maximum. Quick connect terminals (AUX1).

**(8) Sensor Input** - Quick connect terminals (ALM1) for the float switch (signaling device).

**(9) Battery Terminals** - Install a 9VDC lithium battery (not included) for battery backup during power outages.

**(10) Pump Terminal Block** - Connect incoming pump power, pump connections, and pump switch.

**(11) Enclosure and Mounting Holes** - Rated Type 4X (outdoor), includes six mounting holes, lockable latch, and is thermoplastic.

# SPECIFICATIONS

## VersAlarm™ 4X 1-Zone Outdoor Tank Alarm



### Primary Power

120VAC or 240VAC, 50/60 Hz  
(voltage depends on model)

### Secondary Power

9-10VDC, 200mA

### Watts

3.0 Watts

### Field Connection Sensor

9-10VDC, 1mA minimum  
(signaling device)

### Auxiliary Contacts

120VAC, 0.3A maximum  
24VDC, 0.5A maximum  
Normally Open  
Single Pole, Single Throw

### Pump Terminal Block

120/230VAC (pump power)  
15A, 120/230VAC (pump switch)  
Single Pole, Single Throw

### LEDs

Green (power and zone indicator)  
Red (alarm condition and low battery)

### Buzzer

5-30VDC, 95 dB @ 2-feet

### Control Transformer

120VAC or 240VAC, 2.4VA  
(voltage depends on model)

### Battery Backup

Lithium 9VDC battery (not included)

### Enclosure

Thermoplastic  
4 x 4 x 3 (inches)  
Type 4X, Outdoor  
Lockable Latch

### Certifications

CSA (US and Canada)

### Three-Year Limited Warranty

## Altra™ Control Switch



### Electrical

5 Amp and 5 Amp or 1mA, 120/240VAC

### Operating Temperature

0 - 140° F

### Cable Type (bare leads)

SJOOW (UL/CSA), 18 gauge, 2-conductor,  
flexible, and water/oil resistant

### Float Housing

Polypropylene

### Switch Configuration

Single Pole, Single Throw  
(normally open or normally closed)

### Switching Differential

20° total (narrow angle)

### Certifications

CSA (US and Canada)

### Three-Year Limited Warranty

# MECHANICAL DRAWING

VersAlarm™ 4X 1-Zone Outdoor Tank Alarm (Cover On and Cover Off)

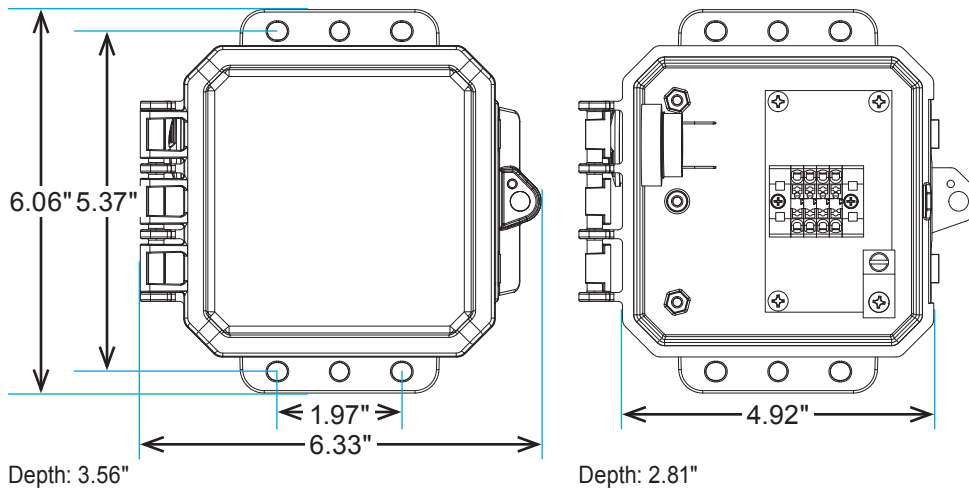

Altra™ Control Switch

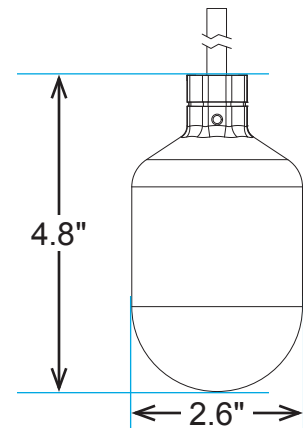

# PUMP TERMINAL BLOCK

- Incoming Pump Power = Bottom Side of TB1 and TB2
- T1 and T2 Pump Connections = Bottom Side of TB3 and TB4
- Pump Switch (bare lead) = Top Side of TB1 and TB3
- Jumper Wire (use 14 AWG) = Top Side of TB2 and TB4

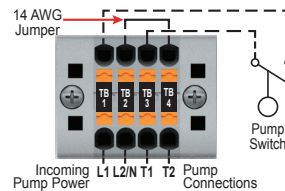

**CAUTION:** Maximum wire size for the terminals is 12 gauge (AWG). Pumps must contain integral thermal overload protection.

# ORDERING INFORMATION

For a complete list of standard products with pricing, refer to the current year price sheet or visit [alderonind.com](http://alderonind.com) for more information.

PART NUMBER	DESCRIPTION (Alarm Panel includes: Auto Reset, Battery Backup, and Auxiliary Contacts)
2000229*	VersAlarm™ 4X, 1-Zone, Type 4X - Outdoor Tank Alarm with Pump Terminal Block, 120VAC
2000230*	VersAlarm™ 4X, 1-Zone, Type 4X - Outdoor Tank Alarm with Pump Terminal Block, 120VAC, High Level, 15' Alarm Float, RubberLox™ Pipe Clamp
2000231*	VersAlarm™ 4X, 1-Zone, Type 4X - Outdoor Tank Alarm with Pump Terminal Block, 120VAC, High Level, 20' Alarm Float, RubberLox™ Pipe Clamp
2000237*	VersAlarm™ 4X, 1-Zone, Type 4X - Outdoor Tank Alarm with Pump Terminal Block, 120VAC, Low Level, 15' Alarm Float, RubberLox™ Pipe Clamp
2001078	15' Altra™ Narrow Angle Control Switch, 120/240VAC, 5A, Normally Open (high level or pump down), RubberLox™ Pipe Clamp, Bagged
2001105	20' Altra™ Narrow Angle Control Switch, 120/240VAC, 5A, Normally Open (high level or pump down), RubberLox™ Pipe Clamp, Bagged
2001087	15' Altra™ Narrow Angle Control Switch, 120/240VAC, 5A, Normally Closed (low level or pump up), RubberLox™ Pipe Clamp, Bagged

(\* Indicates Part Number Replacements:

2000229 = 7031B and 2000235

2000230 = 7004B and 2000232

2000231 = 7032B and 2000233

2000237 = 7033B and 2000239