

TECHNICAL DATA SHEET No. 13

Reece Safety Products Ltd

Unit B9, Lowfields Close, Lowfields Business Park, Elland, West Yorkshire HX5 9DX

Tel: 01422 310456 Fax: 01422 311070 Email sales@reecesafety.co.uk www.reecesafety.co.uk



Product Information and Assembly Instructions - MCB 'Toggle' Lock CB12

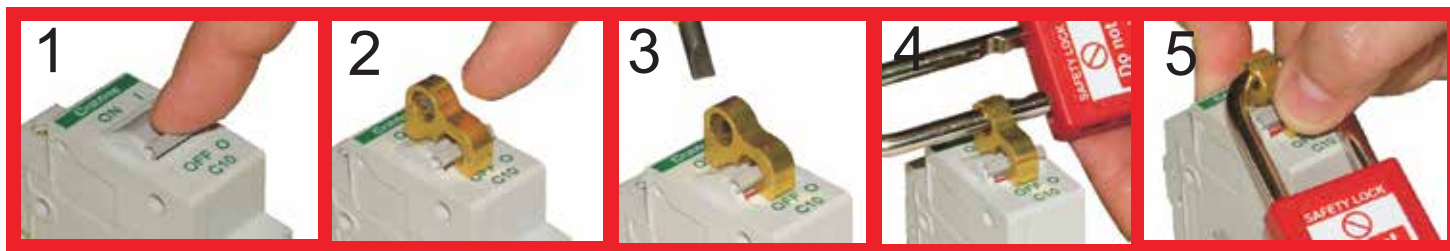

The CB12 can be used to lock breakers which have no locking facilities.

- 1 Place circuit breaker in the OFF position (figure 1)
- 2 Place the CB12 over the circuit breaker toggle as shown (figure 2).
- 3 Using a small screwdriver, tighten the internal grub screw securing the CB12 onto the toggle (figure 3).
- 4 Place a lockout padlock through the hole as shown (figure 4).
- 5 Verify that the circuit breaker toggle is securely fastened and cannot be switched on (figure 5).

Product Information and Assembly Instructions - Grip Tight MCB Lockouts CB13 & CB14

Two styles available:

Model CB13 locates sideways onto the toggle and is ideal for tall and wide toggles

Model CB14 locates over the toggle and is ideal for use with single and double toggles



CB13

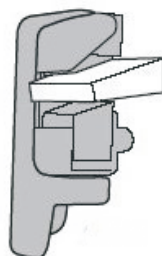

CB14



EASY OPERATION

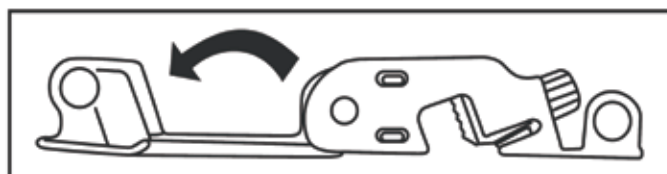

2. Place CB14 lockout over breaker toggle [CB13 fits sideways]. Turn black knob clockwise until grips touch toggle. Do not overtighten. When the handle is closed the grips will tighten against the toggle.

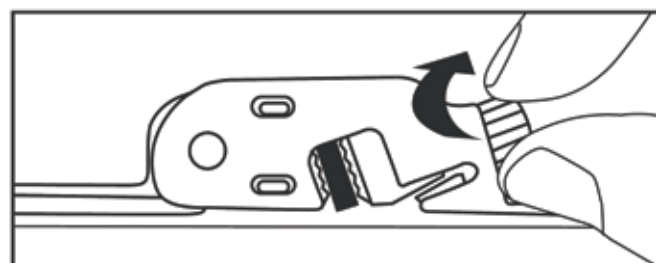

3. Move lockout handle to closed position. Check that lockout is secure and breaker can not be moved to "on" position. Apply padlock.

